

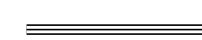

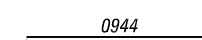

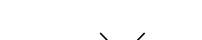

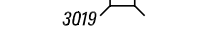
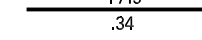
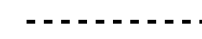

TOTAL MILES	
Township Road System	56.89
State Highway System	25.95
Total	82.84

LEGEND

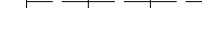
-  LIMITED ACCESS HIGHWAY
-  STATE ROUTE AND NUMBER
-  STATE MAINTAINED BRIDGE ON TOWNSHIP ROAD
-  TOWNSHIP ROAD, NUMBER AND SEGMENT LENGTH IN MILES
-  IMPASSABLE TOWNSHIP ROAD
-  OTHER ROAD
-  RAILROAD (IN SERVICE)
-  RAILROAD ABANDONED (TRACK RETAINED)
-  STATE BOUNDARY
-  COUNTY BOUNDARY
-  TOWNSHIP BOUNDARY
-  CITY OR BOROUGH BOUNDARY
-  MUNICIPAL BUILDING
-  SPLIT MILEAGE BETWEEN MUNICIPALITIES

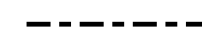

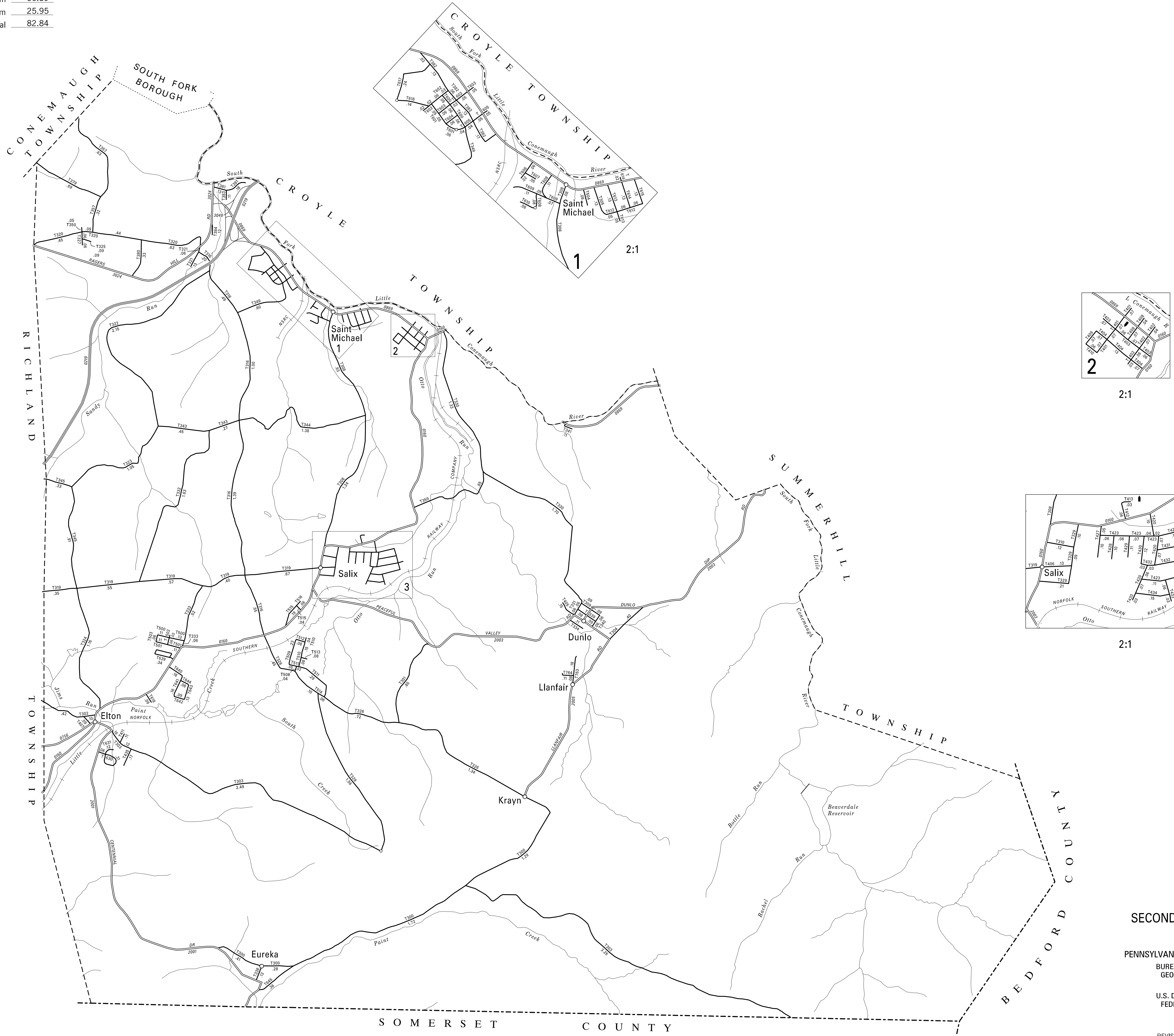
- 300 MINE 42 RD
- 301 PETA RD
- 302 MI AIRY RD
- 303 OUL BEDFORD PK
- 304 PIPELINE RD
- 305 THIRD ST
- 306 WPA RD
- 307 COULTER ST
- 310 SCHOOL ST
- 318 PALESTINE RD
- 319 OAKRIDGE RD
- 320 MI HOPE RD
- 321 GRAMINGTON RD
- 322 WATER DAM RD
- 323 WEAVER RD
- 324 HELSER DR
- 325 RIM DR
- 326 KRAYN RD
- 327 HUB LA
- 328 SADDLE CLUB RD
- 329 WISSINGER ST
- 330 SEESTOWN RD
- 331 PITCHFURN AV
- 332 BLUE RD
- 333 BAUMGARDNER RD
- 334 RAILROAD ST
- 338 CLUB RD
- 339 DONDONG ST
- 340 ROBERTS AV
- 341 CHEY LA
- 343 CEDAR PRESS RD
- 344 TOPPER RD
- 345 FIFTY ACRE RD
- 349 ROCK DUMP RD
- 350 WISDOM ST
- 357 BEAGLE CLUB RD
- 359 RHODES CROSS RD
- 379 HOLLOW RD
- 380 COUNTRY INN RD
- 381 ANGLE RD
- 382 MAIN ST
- 383 HARLEY ST
- 384 LIBERTY PARK RD
- 401 GROVE ST
- 402 MEADOW ST
- 403 CHURCH ST
- 404 CROWN ST
- 405 HUFF ST
- 406 CHERRY ST
- 407 POST ST
- 408 MAPLE ST
- 409 PARK ST
- 410 HILL ST
- 411 SHERRY DR
- 412 MARY DR
- 413 MAYNE DR
- 420 ADAMS DR
- 423 BEAUTYLINE DR
- 427 MAPLE CT
- 428 PINE CT
- 429 SPRUCE CT
- 430 WILLOW DR
- 431 POPLAR DR
- 432 HICKORY DR
- 433 REDWOOD DR
- 434 LOCUST DR
- 435 CATHERINE DR
- 500 RIDGEVIEW DR
- 501 CRESTVIEW DR
- 502 GARDNER AV
- 503 BAUM AV
- 504 SECOND ST
- 508 PINE ST
- 509 BEECH ST
- 510 OAK ST
- 511 LUTHER ST
- 512 HEMLOCK CT
- 513 MAPLE PARK ST
- 514 WOOD ST
- 515 MILLER RD
- 516 MILLER LA
- 600 LAKE AV
- 601 PARKWAY AV
- 602 STATION ST
- 603 MARKET ST
- 604 BRIDGE ST
- 605 FRANKLIN ST
- 606 FIRST ST
- 607 WALKER AV
- 608 SCHOOL RD
- 609 MARYLAND AV
- 610 HILLSIDE AV
- 611 TANK AV
- 612 CRESLO AV
- 613 FOURTH ST
- 614 FIFTH ST
- 615 SIXTH ST
- 616 FOX DR
- 617 CHAPEL ST
- 618 NEALYN DR
- 620 KELLY DR
- 631 CLARUTH DR
- 630 GLOORY RD
- 640 BRENDALYN LA
- 641 LYN LA
- 642 BOY LA
- 643 KIM LA
- 644 JERARD LA
- 645 MINE 42 RD EXT
- 763 LLOYD ST
- 764 GOULA ST

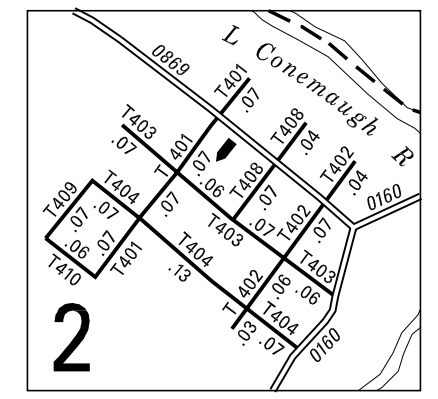

2:1

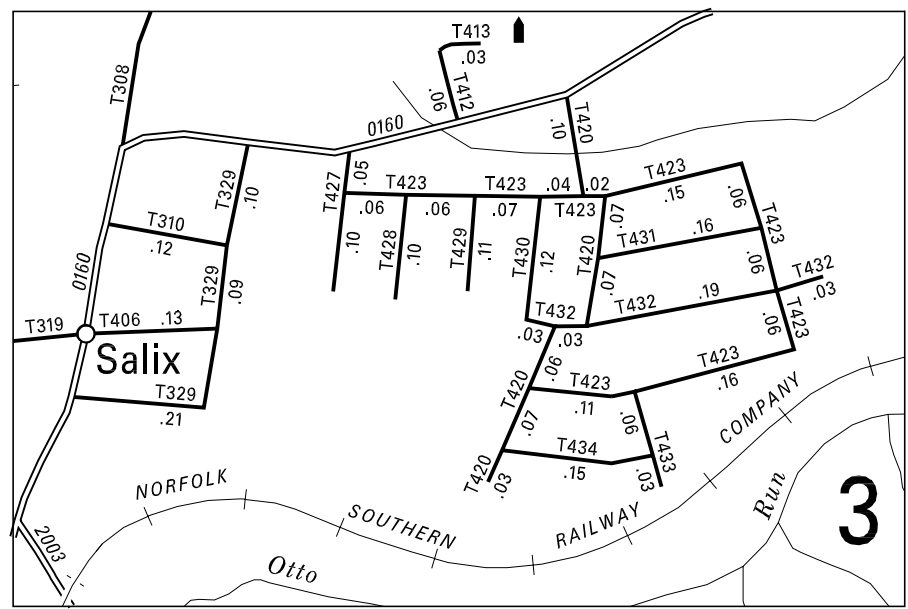

2:1

**ADAMS
SECOND CLASS TOWNSHIP MAP
CAMBRIA COUNTY**

PREPARED BY THE
PENNSYLVANIA DEPARTMENT OF TRANSPORTATION
BUREAU OF PLANNING AND RESEARCH
GEOGRAPHIC INFORMATION DIVISION
IN COOPERATION WITH THE
U.S. DEPARTMENT OF TRANSPORTATION
FEDERAL HIGHWAY ADMINISTRATION
MUNICIPAL CODE 11 201

REVISED PER FORM 990 DATED 8-15-07

